



# CA-HX500C

Supporting LumiTrax™ 16x Speed 5-megapixel Colour camera



\*Please note that accessories depicted in the image are for illustrative purposes only and may not be included with the product.

This model has been discontinued.

Compliance with the certification standard is ensured as of the time of shipment from our company.

Contact Us: 1-888-539-3623

Recommended Replaceable Products: [16× speed, high-performance 5 megapixel camera \(Color\) - CA-H500CX](#)

## Specifications

Model		CA-HX500C
Image element		Color CMOS image receiving element, 16× high-speed reading using square-pixel, Unit cell size: 5 μm × 5 μm <a href="#">0.20 Mil × 0.20 Mil</a>
Valid pixel count		5 M-pixel mode: 4.96 M pixels, 2432 (H) × 2040 (V), 2 M-pixel mode: 1.92 M pixels, 1600 (H) × 1200 (V)
Image size		Equivalent to 1 "
Scanning system		Progressive 29.0 ms: 5 M-pixel mode, 11.6 ms: 2 M-pixel mode*1, 52.4 ms: 5 M-pixel mode, 20.2 ms: 2 M-pixel mode*2
Pixel transfer frequency		195 MHz (×16 speed) *1 130 MHz (×11 speed) *2
Electronic shutter		Can be set to 0.01 to 100 msec by specifying the following numerical inputs: 1/15, 1/30, 1/60, 1/120, 1/240, 1/500, 1/1000, 1/2000, 1/5000, 1/10000, 1/20000, 1/50000, 1/100000
Environmental resistance	Ambient temperature	0 to +40 °C <a href="#">32 to 104 °F</a>
	Relative humidity	35 to 85 % RH (no condensation)
Camera cable		High-speed camera cable CA-CHxx
Weight		Approx. 280 g (not including lens)

\*1 When using the CV-X400 or CV-X200 Series with the CA-EC80HX/EC80L  
\*2 When the camera input unit CA-EC80 is used with a CV-X100 Series controller or with a CV-X200 Series controller

## Dimensions

\* Download CAD file or product manual for larger image/text and more detail.

ca-hx500c\_dimension\_01.gif

CA-HX500C

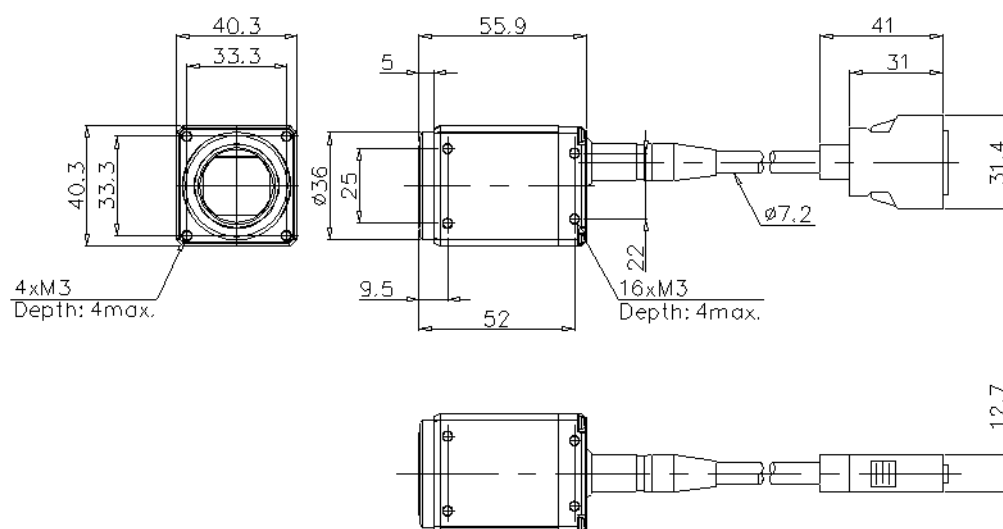

When plastic fitting (accessory) is attached

